

Spanware™ IMP-Anchors are easily installed with common tools. Their aggressive thread profile and expanding castellated ferrule ensure a snug, watertight attachment to walls made from insulated metal panels, and provide for a sanitary, food grade installation. Installation procedure is as follows:

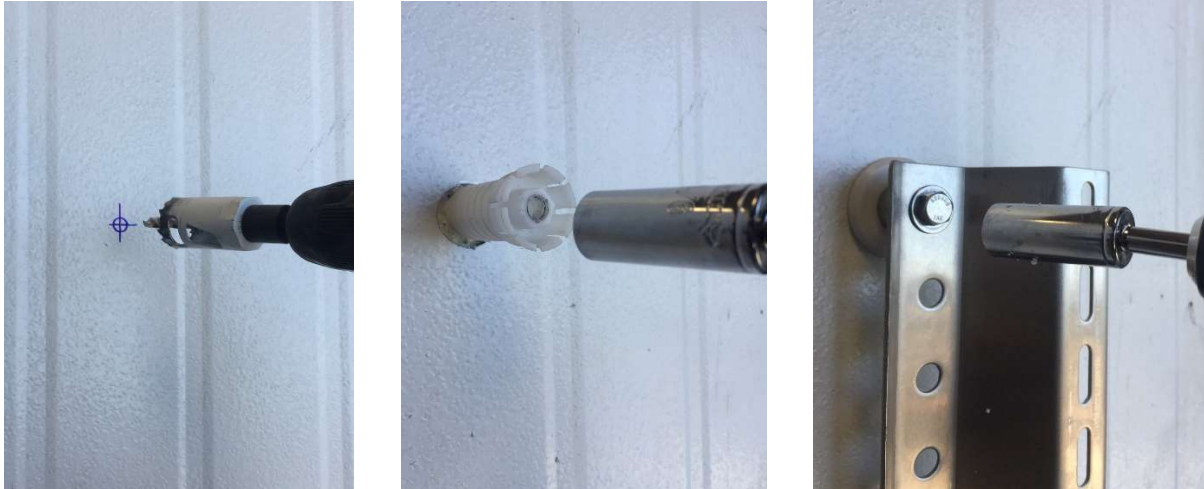

Installation Procedure:

1. Drill through exterior steel lamination with a 1-1/8" diameter hole saw. Only drill through first steel lamination and do not continue drilling into polystyrene/polyurethane core.
2. Insert threaded screw section and drive into the insulated metal panel until the barbs of the castellated ferrule just "snap past" the steel lamination.
3. Push the 3/8" x 2-1/4" stainless steel cap screw through the stainless steel flat washer, then through the flange of the item to be attached to the wall, then through the wall spacer, the gasketed thrust washer, and then into the threaded screw section.
4. Tighten bolt to 4 ft*lbs. Do not over tighten the assembly. Over tightening the assembly will cause fastener/substrate failure and will compromise the assembly's ability to bear load.